

PFR500(-R), PFR501(-R)

**PHASE FAILURE RELAYS
THREE PHASE (THREE WIRE)
WITH OPTIONAL PHASE SEQUENCE MONITORING**

A range of phase failure relays designed to monitor the phase voltage of systems without a neutral connection, and trip at user set limits.

Two phases are monitored and compared with the third which is used as a reference. Each trip contains a double pole change-over relay configured to energise on normal mains/generator voltages. The required trip level is set on the front facia 'set volts' control. An LED lights to indicate that the relay is energised and the voltage is within limits.

The PFR's trip relay de-energises if any of the phase to phase voltages fall below the 'set volts' level. The relay does not energise until all phase voltages are restored to above the 'set volts' level plus the pre-set hysteresis voltage.

A phase sequence monitoring circuit is available as an option. With this feature fitted, the relay will not energise unless the correct phase sequence is connected.

The PFR500 range is housed in a standard DIN rail mounted case.

Standard units:-

- PFR500** Phase failure relay, three phase three wire for nominal 400 V AC ph-ph systems
- PFR500-R** As above, plus phase sequence monitoring
- PFR501** Phase failure relay, three phase three wire for nominal 190 V AC ph-ph systems
- PFR501-R** As above, plus phase sequence monitoring

For voltages other than the above, please contact our Modexsales office.

When ordering, please specify:-

- a) Product type number
- b) Nominal input/supply voltage (phase to phase)

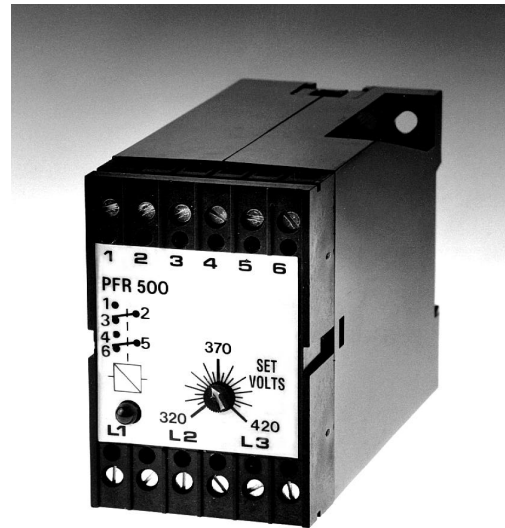

Product Specifications

	PFR500(R)	PFR501(R)
Input/Power supply:		
trip range (V AC, ph-ph)	320 – 420	170 – 230
hysteresis (V AC, ph-ph)	10	5
max. input (V AC, ph-ph)	480	280
power consumption	< 5 VA	
operating freq. range	45 – 65 Hz.	
Relay output:		
contact type	volt free DPCO contacts	
current rating	5 A max. @ 240 V AC1	
rated operations	2 x 10 ⁵	
trip time	approx. 500 mS	
General:		
operating temp.	-10 to +55°C	
weight	< 400 g	
EMC emission/immunity	to EN50081-2/EN50082-2	

Connection

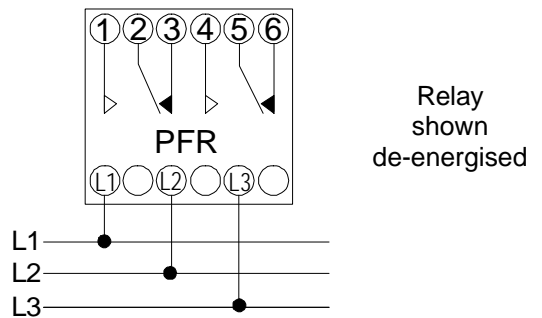

Dimensions

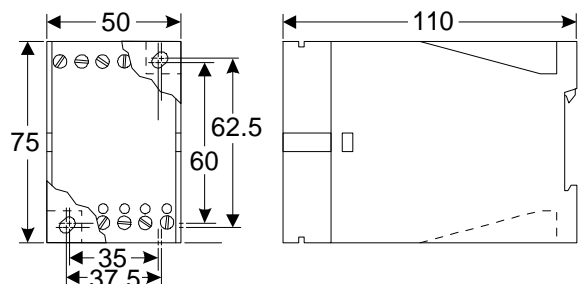

Frank W. Murphy Manufacturer
PO Box 470248, Tulsa, Oklahoma 74147, USA
Tel: + 1 918 627 3550 Fax: + 1 918 664 6146
email: sales@fwmurphy.com
web: http://www.fwmurphy.com

Frank W. Murphy Ltd.
Incorporating Modex Automation
Church Road, Laverstock, Salisbury U.K.
Tel: + 44 1722 410055 Fax: + 44 1722 410088
Pour service en Français: tél: + 44 1722 410697
email: sales@fwmurphy.co.uk
web: http://www.fwmurphy.co.uk

Frank W. Murphy Southern Division
PO Box 1819, Rosenberg, Texas 77471, USA
Tel: + 1 281 342 0297 Fax: + 1 281 341 6006
email: sales@fwmurphy.com

Murphy Switch of California
PO Box 900788, Palmdale, California 93590, USA
Tel: + 1 805 272 4700 Fax: + 1 805 947 7570
email: sales@murphyswitch.com
web: http://www.murphyswitch.com

Frank W. Murphy Ltd. en France
Tel: + 33 (1) 30 76 26 26 Fax: + 33 (1) 30 76 39 89
Direct usine Tel: +44 1722 410697
email: sales@fwmurphy.co.uk

Murphek Pty. Ltd.
1620 Hume Highway, Campbellfield, Vic. 3061 Australia
Tel: + 61 3 9358 5555 Fax: + 61 3 9358 5558
email: murphy@macquarie.com.au

Frank W. Murphy Pte. Ltd.
No. 2 Tuas South Street 2, Sprintecs Building
#02-01/02, Singapore 637895
Tel: +65 863 1398 Fax: +65 863 0208
email: fwmurphy@fwmurphy.com.sg

Murphy de Mexico S.A. de C.V.
Bld. Antonio Rocha Cordero 300, Fracción del Aguaje
San Luis Potosí, S.L.P., México 78384
Tel: + 52 48 206264 Fax: + 52 48 206336
email: murmexsl@sanluis.podernet.com.mx